

A statement of probable construction cost should be prepared at the end of which of the following phases? *Choose 3 that apply.*

site analysis

site inventory

schematic design

design development

construction documents

bidding and negotiations

construction contract administration

The following are **MOST LIKELY** included in an initial design budget. *Choose 4 that apply.*

- profit
- staff time
- direct costs
- consultant costs
- construction labor cost
- additional services cost
- construction materials cost

Which of the following are essential considerations for the management of a park and ecotourism project with respect to natural resources? *Choose 2 that apply.*

transportation systems

the fragmentation of habitats

human demands on the ecosystem

the species of plants to be planted around new structures

What are the primary purposes of arterial streets? *Choose 2 that apply.*

- serve as the link between local streets
- move as much traffic as efficiently as possible
- serve through traffic traveling relatively long distances
- provide easy access to adjacent commercial development

This illustrates a typical natural area. Identify the location that is the most active and sensitive wildlife habitat area. *Select the area in the boxes provided.*

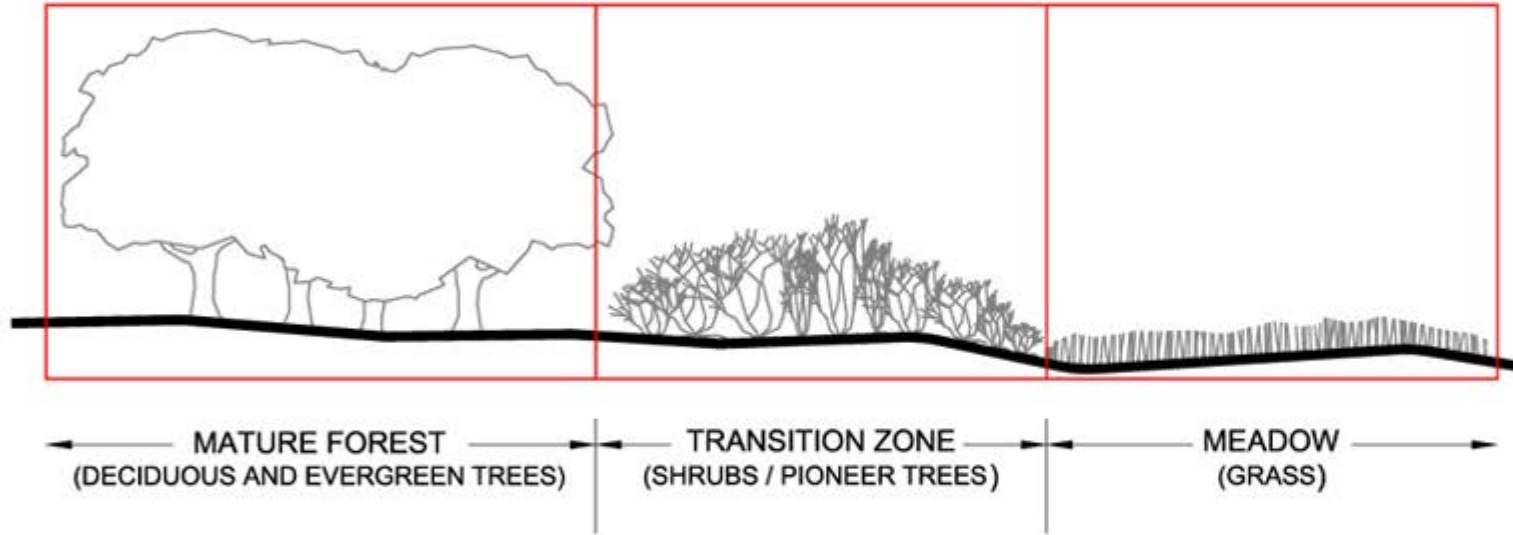

A warehouse project is planned on a site adjacent to an existing nature center. Which plan minimizes impacts to the nature center and environmental features? *Select the plan.*

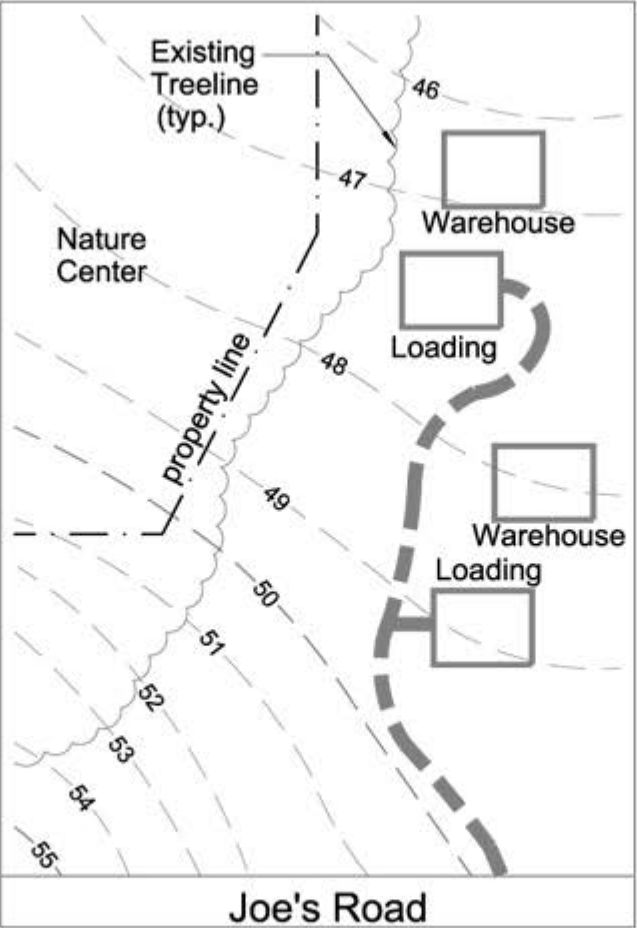
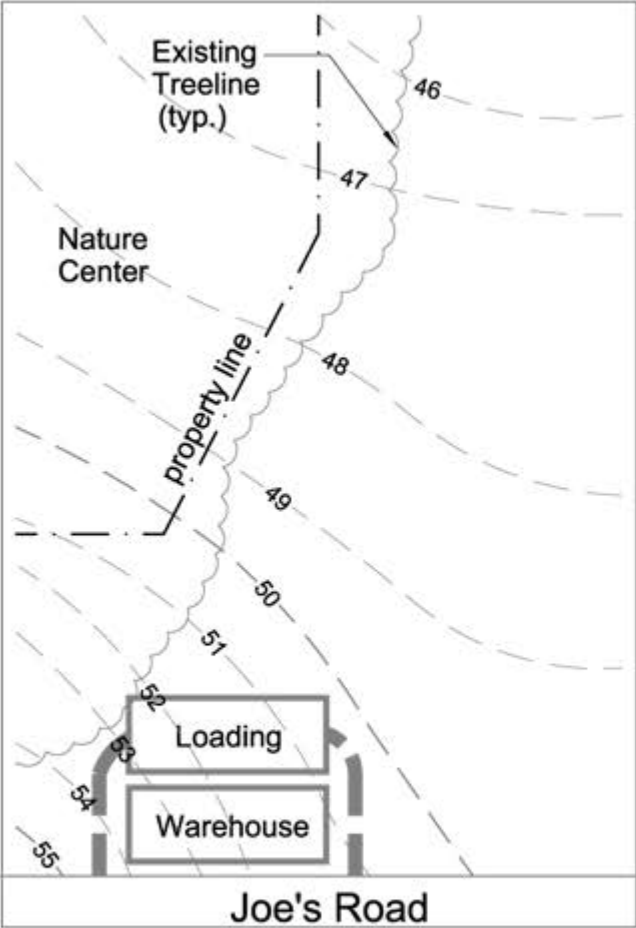

Refer to the exhibit. Prepare a design for a community center complex based on the client's functional relationship diagram. *Place elements to respond to on-site and off-site conditions.*

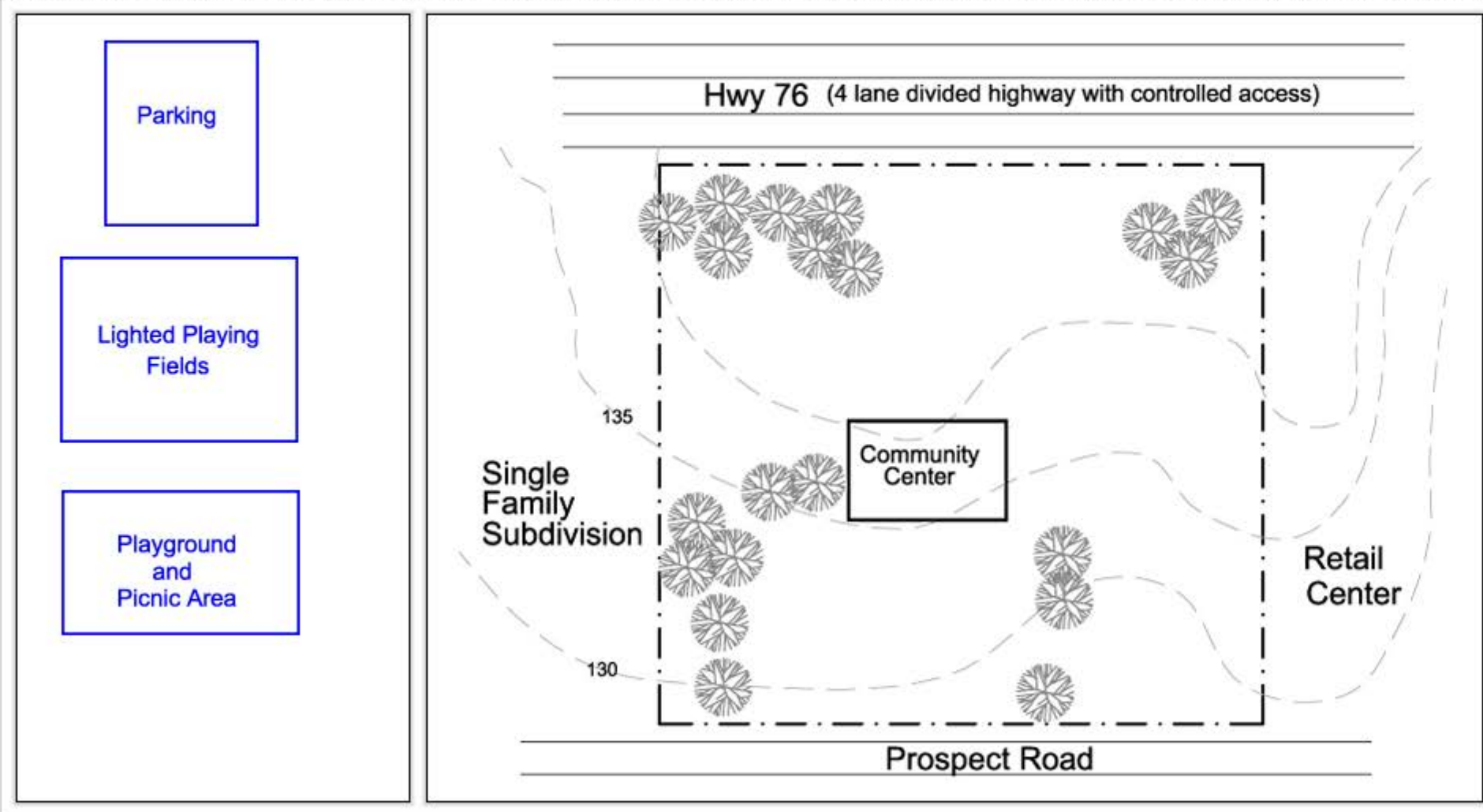

FUNCTIONAL RELATIONSHIP DIAGRAM

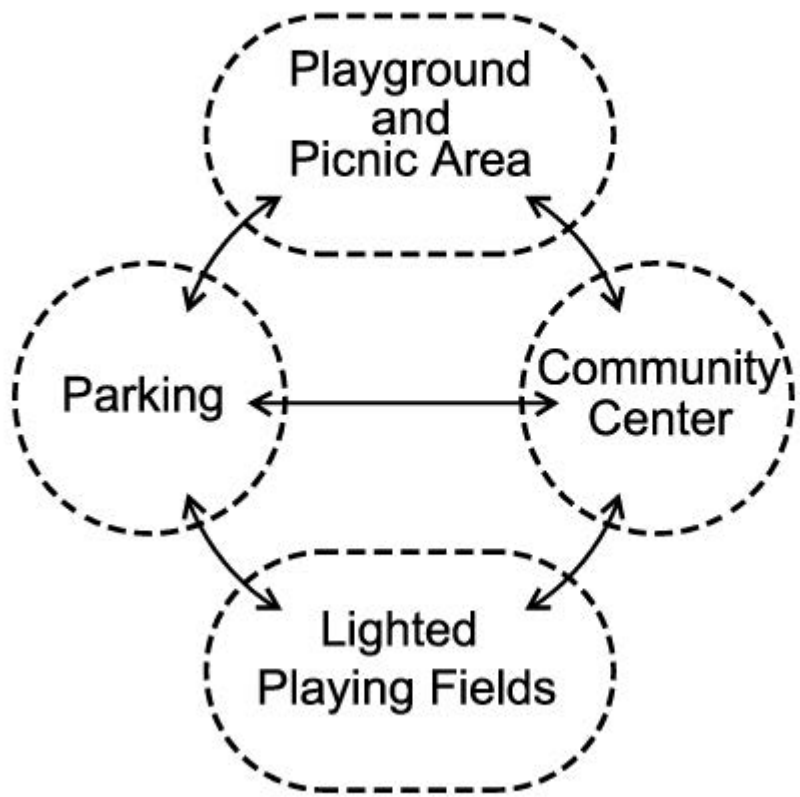

A software company will be constructing a new building for their offices on the site shown below. The new building will be a two-story structure with windows on all sides. Zelkova Avenue is a two lane collector with wide shoulders. The company has requested a preliminary concept plan to inform more specific design. Where should the site elements be placed? *Place the elements in their corresponding boxes.*

- Bus Stop
- Preserve Landscape
- Staff Garden
- Dense Plantings
- Parking Area
- Pedestrian Connection
- Preserve Views

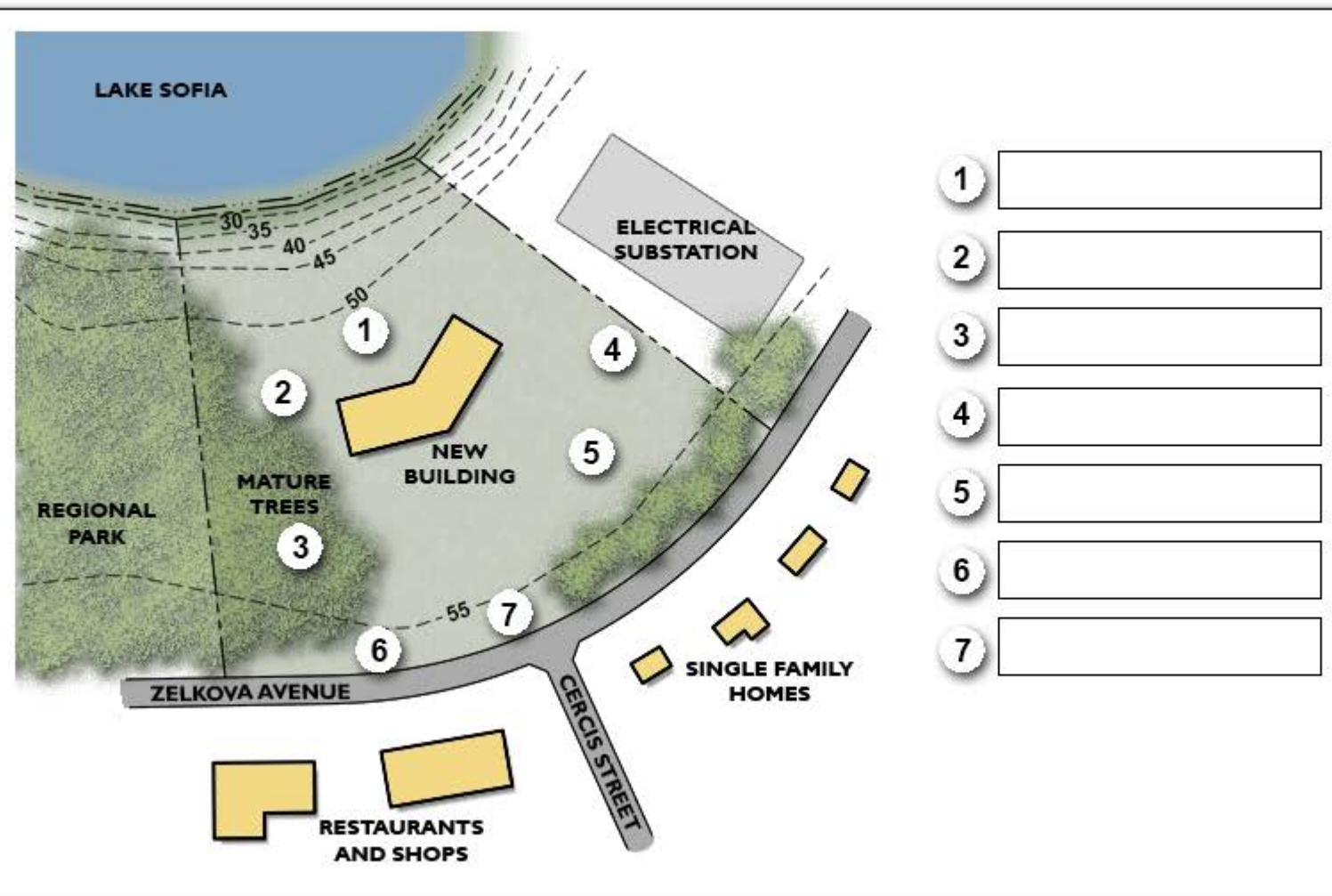

- 1
- 2
- 3
- 4
- 5
- 6
- 7

Identify the most appropriate area on the detention pond to have rip rap installed to prevent scour. *Select the area on the plan.*

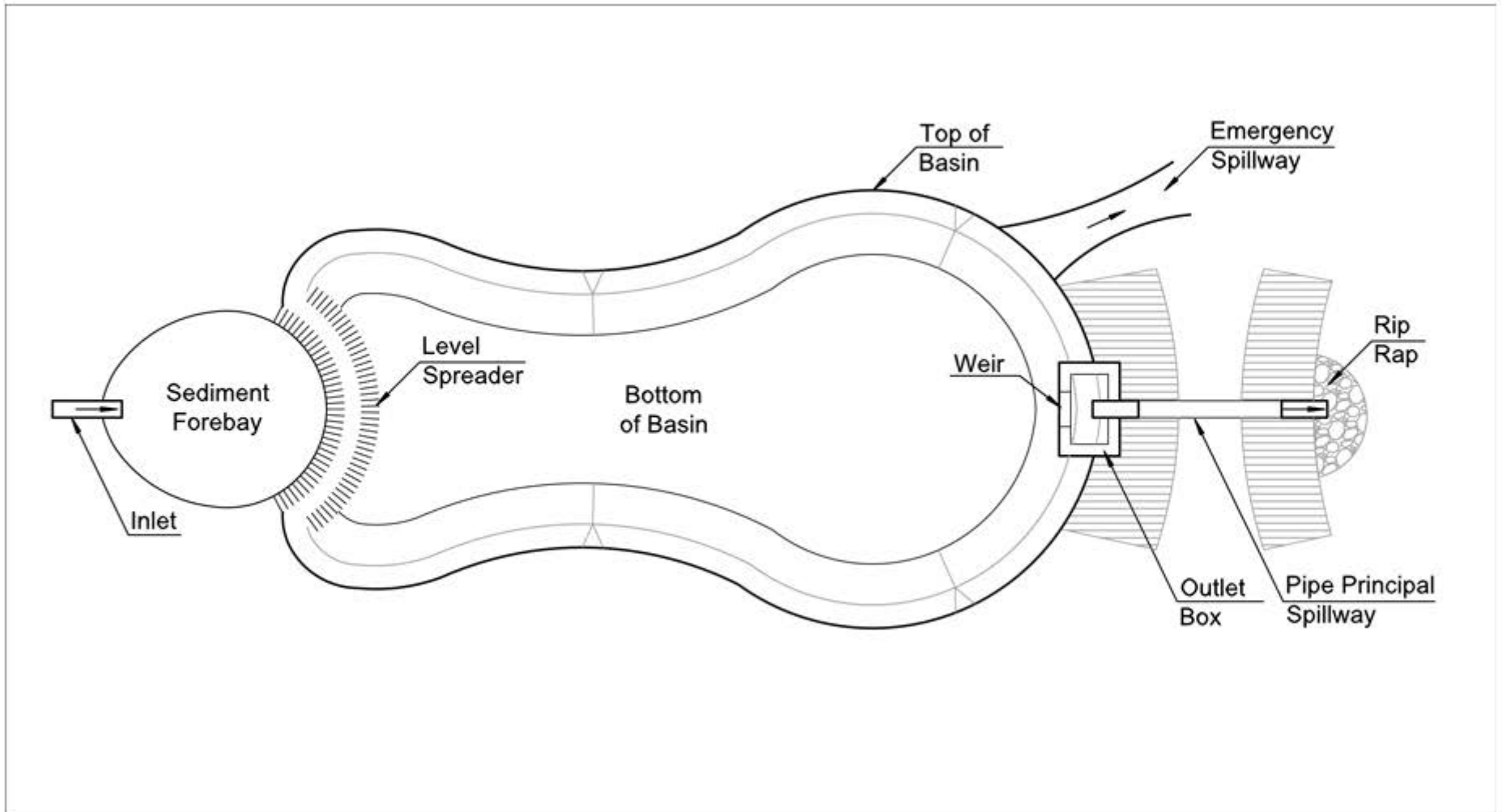

What is the **BEST** location to construct a temporary sediment basin that will capture the greatest amount of runoff from the proposed development areas? *Select the location*

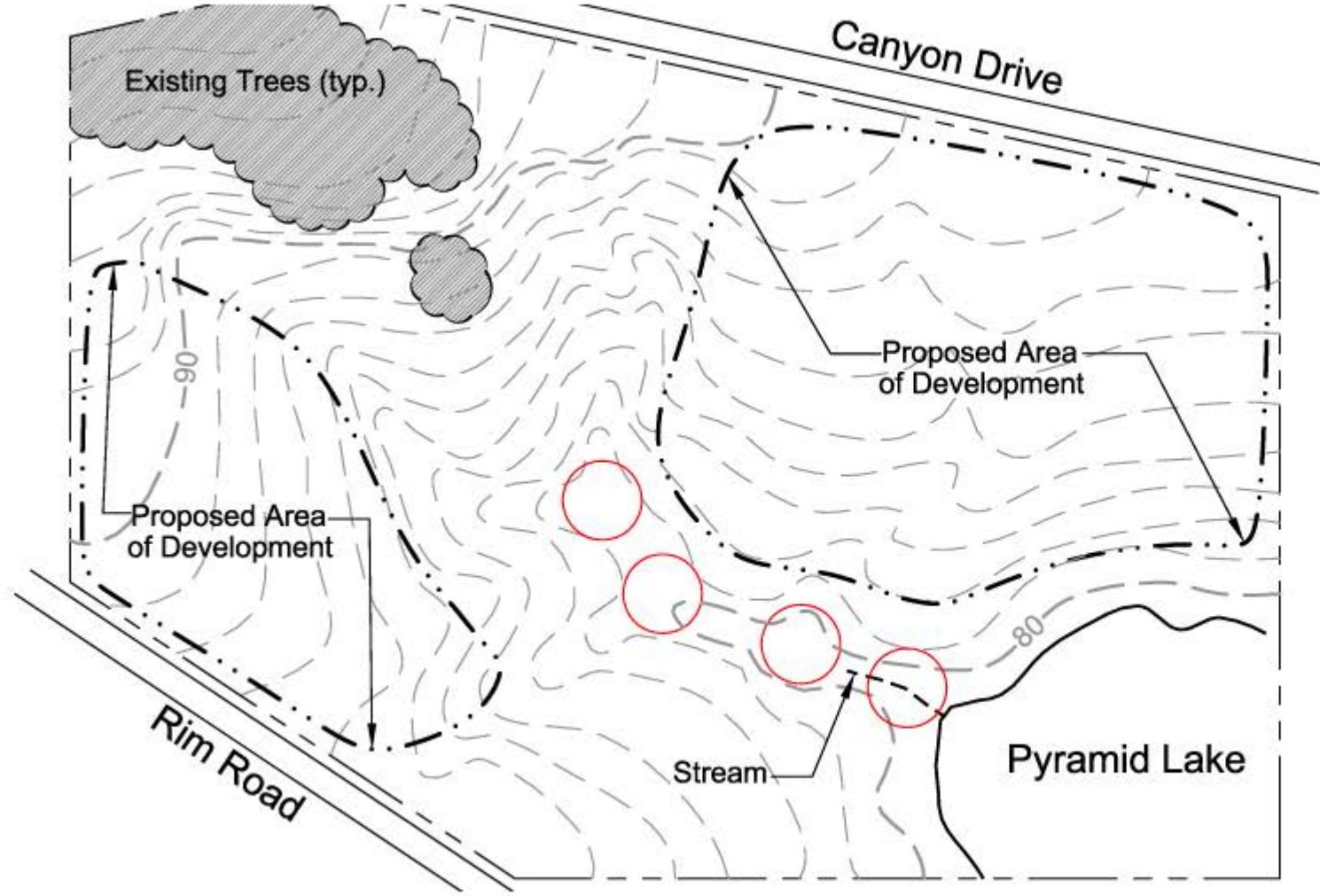

In what order should these construction activities occur from project initiation to substantial completion? *Place the activities in order.*

- INSTALL SUBSURFACE UTILITIES
- ESTABLISH TURF GRASSES
- INSTALL SEDIMENT AND EROSION CONTROLS
- CONSTRUCT BUILDINGS AND SURFACE TREATMENTS
- CLEAR AND GRUB SITE
- PERFORM MASS EARTHWORK

1

2

3

4

5

6

Design a 1-unit deep swale from the parking lot to the bioretention pond. *Place the appropriate contour(s) on the site plan.*

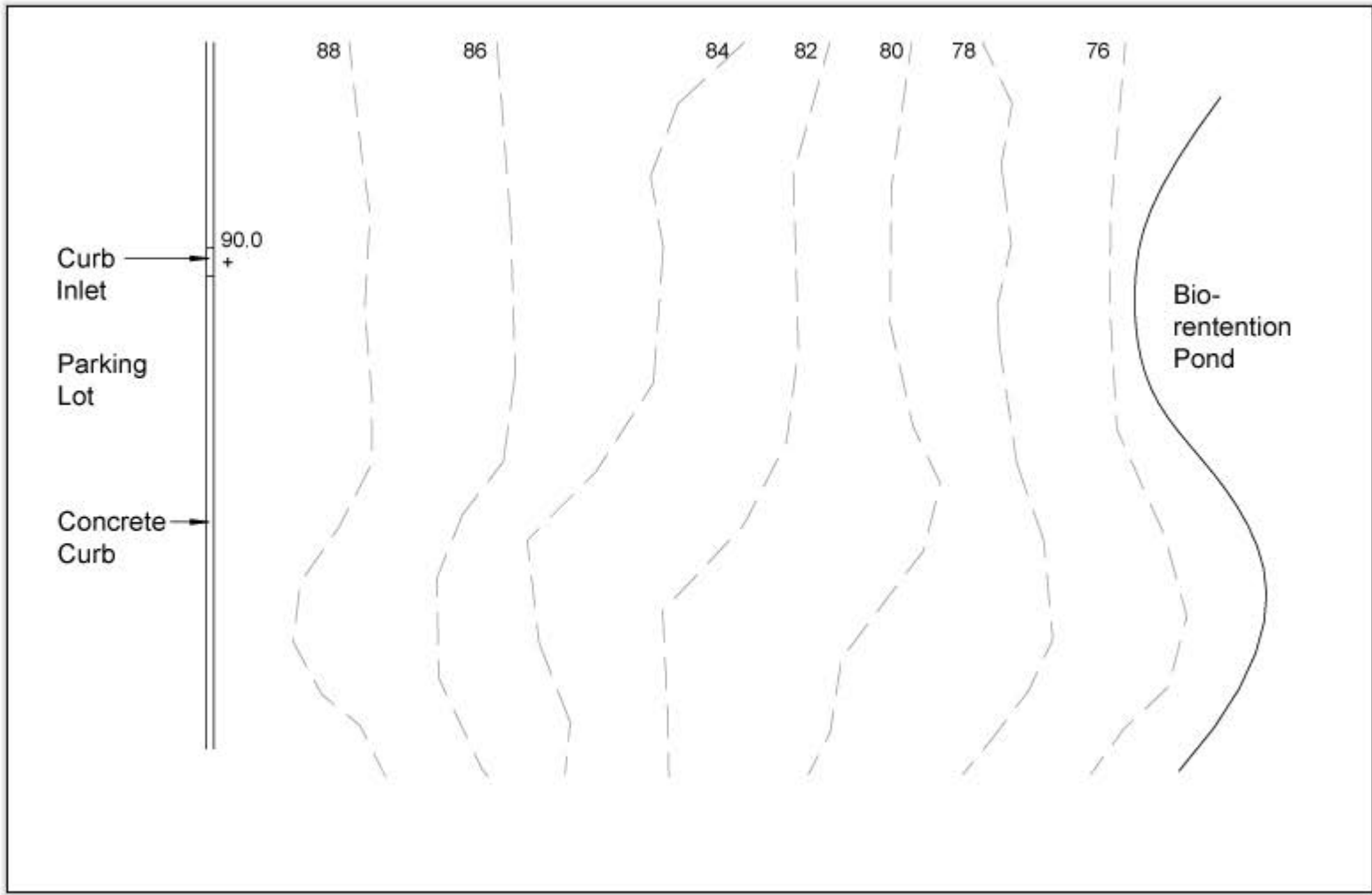
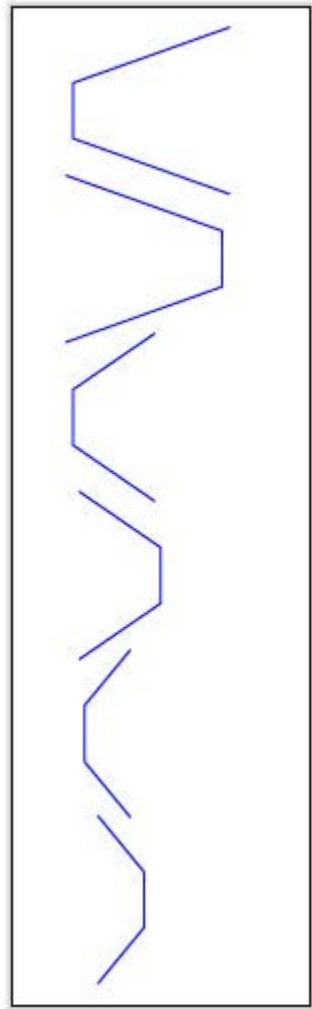

Place the appropriate contours on the site plan to maximize the amount of fill. *Place the contours.*

